

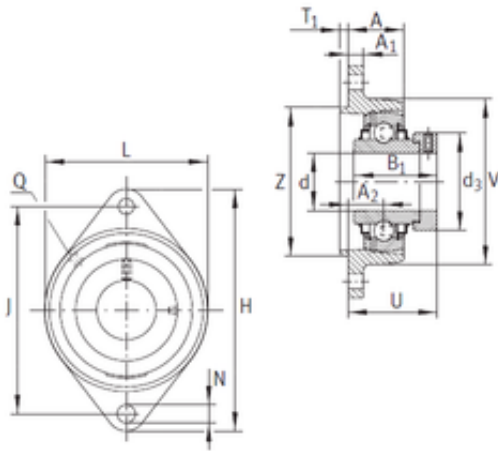

# AMERICAN SKF BEARING MFG.CORP.

## INA RCJTZ40 Flange-Mount Ball Bearing Units



Bearing No. RCJTZ40

Bore Diameter	40 mm
d	40 mm
V	105 mm
U	54,9 mm
Thread (Q)	Rp1/8
T1	4 mm
Z	100 mm
d3	58 mm
A	30,5 mm
A1	13 mm
B1	56,5 mm
H	172 mm
J	143,5 mm
L	105 mm
N	14 mm
A2	20 mm
Weight	1,6 Kg
Basic dynamic load rating (C)	32,5 kN
Category	Flange Block Bearings
Inventory	0.0
Manufacturer Name	SCHAEFFLER GROUP
Minimum Buy Quantity	N/A
Weight / Kilogram	1.69
EAN	4012802066982
Product Group	M06110
Number of Mounting Holes	2

RCJTZ40 Bearing 2D drawings and 3D CAD models



## AMERICAN SKF BEARING MFG.CORP.

Mounting Method	Eccentric Collar
Housing Style	2 Bolt Flange Block
Rolling Element	Ball Bearing
Housing Material	Cast Iron
Expansion / Non-expansion	Non-expansion
Mounting Bolts	14 Millimeter
Relubricatable	Yes
Insert Part Number	GE40KRRB
Seals	Double Land Riding Rubber Contact
Housing Configuration	1 Piece Solid
Pilot Configuration	With Pilot
Inch - Metric	Metric
Long Description	2 Bolt Flange Block; 40MM Bore; 144MM Bolt Circle; 143.5MM Bolt Spacing; 1 Piece Solid; Eccentric Collar Mount; Cast Iron; Ball Bearing; 56.3MM Length Thru Bore; Relubricatable; Double Land Riding Rub
Other Features	Single Row   Centering Spigot   With Set Screw
Category	Flange Block
UNSPSC	31171501
Harmonized Tariff Code	8483.20.40.40
Noun	Bearing
Keyword String	Flanged
Manufacturer URL	<a href="http://www.ina.com">http://www.ina.com</a>
Manufacturer Item Number	RCJTZ40
Weight / LBS	3.726
Length Thru Bore	2.217 Inch   56.3 Millimeter
Cartridge Pilot Depth	0.157 Inch   4 Millimeter
Bore	1.575 Inch   40 Millimeter
Cartridge Pilot Diameter	3.937 Inch   100 Millimeter



## AMERICAN SKF BEARING MFG.CORP.

Bolt Spacing	5.65 Inch   143.5 Millimeter
Nominal Bolt Circle Diameter Round	5.7 Inch   144 Millimeter